

Customer Information Sheet

IF IN DOUBT - ASK

©

NOT TO SCALE

THIRD ANGLE PROJECTION

ALL DIMENSIONS IN mm

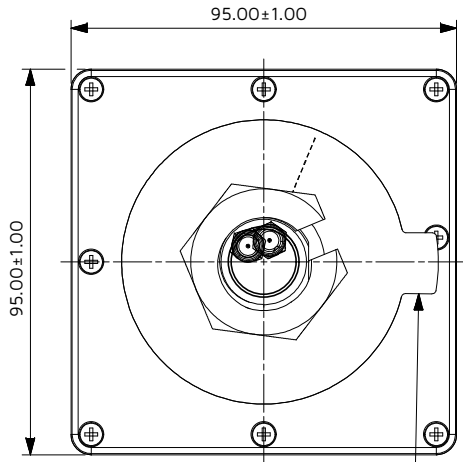

PSA The direction of the handle

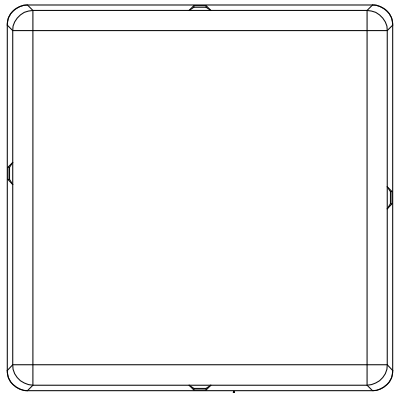
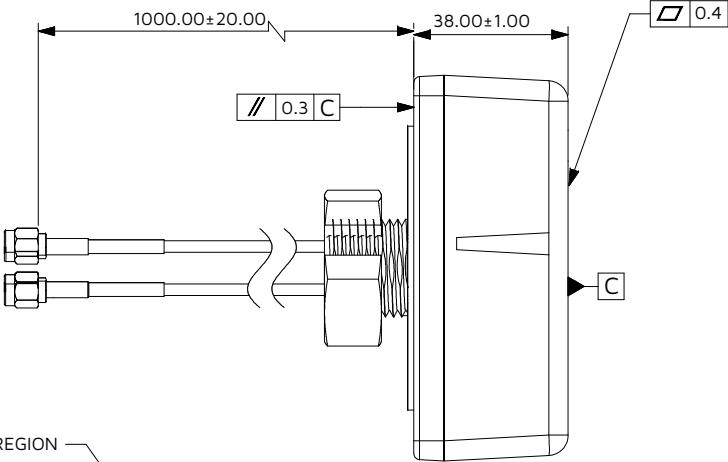

AFTER PRODUCT ASSEMBLY, THE MAX DISLOCATION IS 0.50mm FOR ALL ROUND.

DISPENSING GLUE REGION

The glue is not allowed to overflow the surface by 0.5mm, It must not overflow to the side

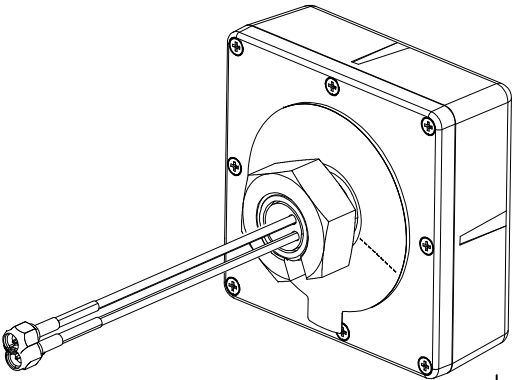
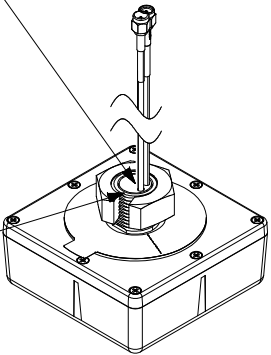

3D VIEW

- Attention
1. Electrical Performance Specification (at room temperature)- Reference product/application Specification.
 2. This product meets the IP67 requirements.
 3. Frequency 5G/LTE: 698-960MHz/1710-2690MHz/3300-5000MHz
 4. Gain : in free space 6.5DBi on metal plate 4.7 dBi
 6. Polarization: Linear
 7. Operating with matching : -40°C to 85°C
 8. Storage with matching : -40°C to 85°C
 9. RF power : 2 Watts
 10. Impedance with matching : 50 Ohms
 11. Cable : RG174
 12. Connector type: SMA STRAIGHT CABLE PLUGS (MALE)

KC	1	08JUL25	--
NAME	ISS.	DATE	CN/CO
APPROVED: WALKER/MEIZY			
CHECKED: THIRI			
DRAWN: KC			

HARWIN

www.harwin.com

TOLERANCES

X. = ±1mm
X.X = ±0.50mm
X.XX = ±0.20mm
X.XXX = ±0.01mm

ANGLES = ±5°
UNLESS STATED

THIS DRAWING AND ANY INFORMATION OR DESCRIPTIVE MATTER SET OUT HEREON ARE CONFIDENTIAL AND COPYRIGHT PROPERTY OF THE HARWIN GROUP AND MUST NOT BE DISCLOSED, LOANED, COPIED OR USED FOR MANUFACTURING, TENDERING OR FOR ANY OTHER PURPOSE WITHOUT THEIR WRITTEN PERMISSION.

MATERIAL & FINISH:

TITLE:

Feed 2in1 ANTENNA

DRAWING NUMBER:

MMANT-1700701-SM2-000

SHT
2
OF
1

Customer Information Sheet

	IF IN DOUBT - ASK	©	NOT TO SCALE	THIRD ANGLE PROJECTION	ALL DIMENSIONS IN mm
--	-------------------	---	--------------	------------------------	----------------------

PEAK GAIN(TYP.)

5G/LTE1 RF PERFORMANCE				
Frequency Range	698-960MHz	1710-2690MHz	3300-4200MHz	4400-5000MHz
in free space	1.0dBi	3.3dBi	3.1dBi	2.8dBi
on metal plate	4.2dBi	6.0dBi	5.2dBi	5.0dBi
5G/LTE2 RF PERFORMANCE				
Frequency Range	698-960MHz	1710-2690MHz	3300-4200MHz	4400-5000MHz
in free space	0.7dBi	6.5dBi	3.6dBi	2.8dBi
on metal plate	4.3dBi	4.7dBi	5.4dBi	4.4dBi

Note:

- 1.Working frequency :
698-960MHz/1710-2690MHz/3300-5000MHz for 5G/LTE MIMO,
- 2.Product peak gain Please refer to the catalog.
- 3.Operating with matching :-40°Cto 85°C
- 4.Storage with matching : -40°C to 85°C
- 5.Impedance with matching :50 Ohms

BOM REFERENCE		
NO.	NAME	Materials
1	TOP HOUSING	Plastic resin PC/ABS
2	BOTTOM COVER	Plastic resin PC/ABS
3	PCB	FR4
4	METAL SHEET	SUS 304
5	SHIELDING	20x20x3.2mm
6	SEALING RING	EPDM Black
7	SCREW	ST2.9 GB/T
8	LTE-1 CABLE	RG174+SMA
9	LTE-2 CABLE	RG174+SMA
10	PSA	FYJD150G
11	NUT	GB-M24
12	FOAM	EVA
13	GNSS FOAM	EVA
14	GLUE	GLUE

KC	1	08JUL25	--
NAME	ISS.	DATE	CN/CO
APPROVED: WALKER/MEIZY			
CHECKED: THIRI			
DRAWN: KC			

HARWIN

www.harwin.com

TOLERANCES
X. = ±1mm
X.X = ±0.50mm
X.XX = ±0.20mm
X.XXX = ±0.01mm

ANGLES = ±5°
UNLESS STATED

THIS DRAWING AND ANY INFORMATION OR DESCRIPTIVE MATTER SET OUT HEREON ARE CONFIDENTIAL AND COPYRIGHT PROPERTY OF THE HARWIN GROUP AND MUST NOT BE DISCLOSED, LOANED, COPIED OR USED FOR MANUFACTURING, TENDERING OR FOR ANY OTHER PURPOSE WITHOUT THEIR WRITTEN PERMISSION.

MATERIAL & FINISH:

TITLE:

Feed 2in1 ANTENNA

DRAWING NUMBER:

MMANT-1700701-SM2-000

SHT
2
OF
2